

Space Arrangement & Floor Plan

First Level

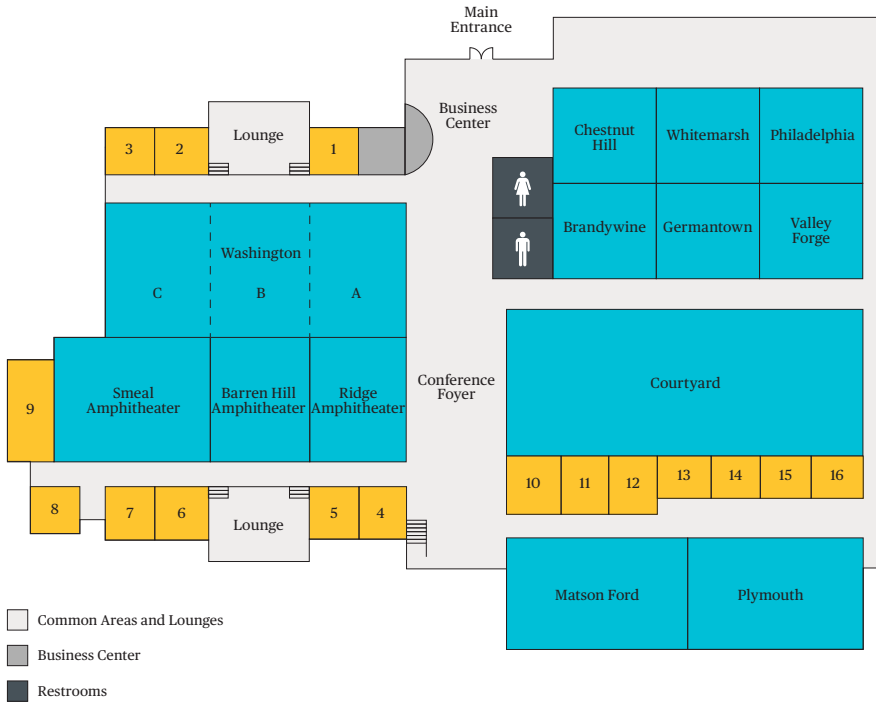

Second Level

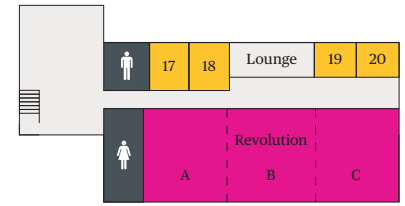

Third Level

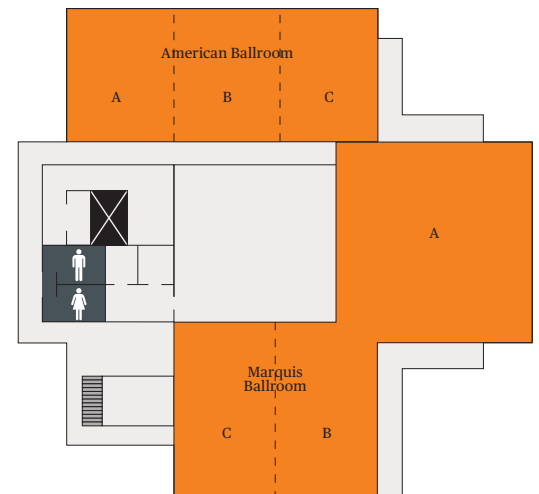

- Common Areas and Lounges (Grey)
- Restrooms (Dark Grey)
- Stair access to/from Dining Room (Light Grey)

Lafayette Complex

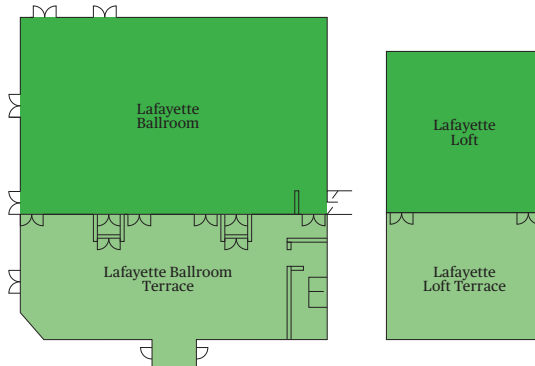

Function Space Capacities

	Square Footage	Length & Width	Ceiling Height	Theater	Classroom	Conference	Collaborative	Pods	U Shape	Rounds	Reception
Lafayette Complex											
Lafayette Ballroom	4,565	83' x 55'	18'	500	300	–	–	243	–	350	500
Lafayette Ballroom Terrace	3,280	82' x 40'	–	–	–	–	–	–	–	220	350
Lafayette Event Deck	13,200	110' x 120'	–	–	–	–	–	–	–	650	1000
Lafayette Loft Terrace	884	34' x 26'	–	–	–	–	–	–	–	–	70
Lafayette Loft	1,107	27' x 41'	14'	–	–	–	–	–	–	–	100
First-Level											
Washington	2,940	84' x 35'	10'	300	216	–	–	126	–	160	–
Washington A	980	28' x 35'	10'	80	50	20	–	42	27	50	–
Washington B	980	28' x 35'	10'	80	50	20	–	42	27	50	–
Washington C	980	28' x 35'	10'	80	50	20	–	42	27	50	–
Smeal Amphitheater	1,230	30' x 41'	10'	–	60	–	–	–	–	–	–
Barren Hill Amphitheater	784	28' x 28'	10'	–	32	–	–	–	–	–	–
Ridge Amphitheater	784	28' x 28'	10'	–	32	–	–	–	–	–	–
Matson Ford	1,392	48' x 29'	10'	146	84	44	–	60	39	80	–
Plymouth	1,189	41' x 29'	10'	112	61	34	–	54	37	60	–
Chestnut Hill	588	21' x 28'	10'	40	30	20	–	24	19	30	–
White Marsh	588	21' x 28'	10'	40	30	20	–	24	19	30	–
Philadelphia	588	21' x 28'	10'	40	30	20	–	24	19	30	–
Brandywine	588	21' x 28'	10'	40	30	20	–	24	19	30	–
Germantown	588	21' x 28'	10'	40	30	20	–	24	19	30	–
Valley Forge	588	21' x 28'	10'	40	30	20	–	24	19	30	–
Second-Level											
Revolution	1,932	69' x 28'	10'	152	112	–	–	90	60	120	–
Revolution A	644	23' x 28'	10'	48	30	20	–	24	21	40	–
Revolution B	644	23' x 28'	10'	48	30	20	–	24	21	40	–
Revolution C	644	23' x 28'	10'	48	30	20	–	24	21	40	–
Parlour	729	27' x 27'	10'	–	–	–	–	–	–	40	70
Marquis Terrace	540	27' x 20'	14'	–	–	–	–	–	–	30	45
Marquis Patio	729	27' x 27'	–	–	–	–	–	–	–	40	60
Marquis Event Deck	2,840	71' x 40'	–	–	–	–	–	–	–	192	250
Third-Level											
American Ballroom	2,673	81' x 33'	10'	150	119	–	–	108	50	150	225
American A	891	33' x 27'	10'	60	56	24	–	36	30	50	75
American B	891	33' x 27'	10'	60	56	24	–	36	30	50	75
American C	891	33' x 27'	10'	60	56	24	–	36	30	50	75
Marquis Ballroom	5,000	–	12'	–	–	–	–	–	–	280	425
Marquis A	2,915	55' x 53'	12'	–	–	–	–	–	–	230	350
Marquis B	980	35' x 28'	12'	–	–	–	–	–	–	50	–
Marquis C	756	28' x 27'	12'	–	–	–	–	–	–	–	75
Collaboration Studios											
Studio 1	189	13.5' x 14'	8'	–	–	–	6	–	–	–	–
Studio 2	189	13.5' x 14'	8'	–	–	8	–	–	–	–	–
Studio 3	189	13.5' x 14'	8'	–	–	–	10	–	–	–	–
Studio 4	189	13.5' x 14'	8'	–	–	8	–	–	–	–	–
Studio 5	196	14' x 14'	8'	–	–	–	8	–	–	–	–
Studio 6	189	13.5' x 14'	8'	–	–	–	6	–	–	–	–
Studio 7	189	13.5' x 14'	8'	–	–	–	8	–	–	–	–
Studio 8	143	13' x 11'	8'	–	–	6	–	–	–	–	–
Studio 9	318	12' x 26.5'	8'	–	–	12	–	–	–	–	–
Studio 10	156	12' x 13'	8'	–	–	–	10	–	–	–	–
Studio 11	224	14' x 16'	8'	–	–	12	–	–	–	–	–
Studio 12	224	14' x 16'	8'	–	–	–	10	–	–	–	–
Studio 13	154	14' x 11'	8'	–	–	–	6	–	–	–	–
Studio 14	154	14' x 11'	8'	–	–	8	–	–	–	–	–
Studio 15	154	14' x 11'	8'	–	–	–	10	–	–	–	–
Studio 16	112	7' x 16'	8'	–	–	–	8	–	–	–	–
Studio 17	189	13.5' x 14'	8'	–	–	–	10	–	–	–	–
Studio 18	189	13.5' x 14'	8'	–	–	–	10	–	–	–	–
Studio 19	189	13.5' x 14'	8'	–	–	–	8	–	–	–	–
Studio 20	169	13' x 13'	8'	–	–	8	–	–	–	–	–
Studio 21	110	10' x 11'	8'	–	–	–	6	–	–	–	–